

Characteristics:	
Number of teeth	3
Cutting direction	right
Spiral direction	right
Spiral angle	35
Type of face	center cut
Type of shank	DIN 1835 HB

X 5:1

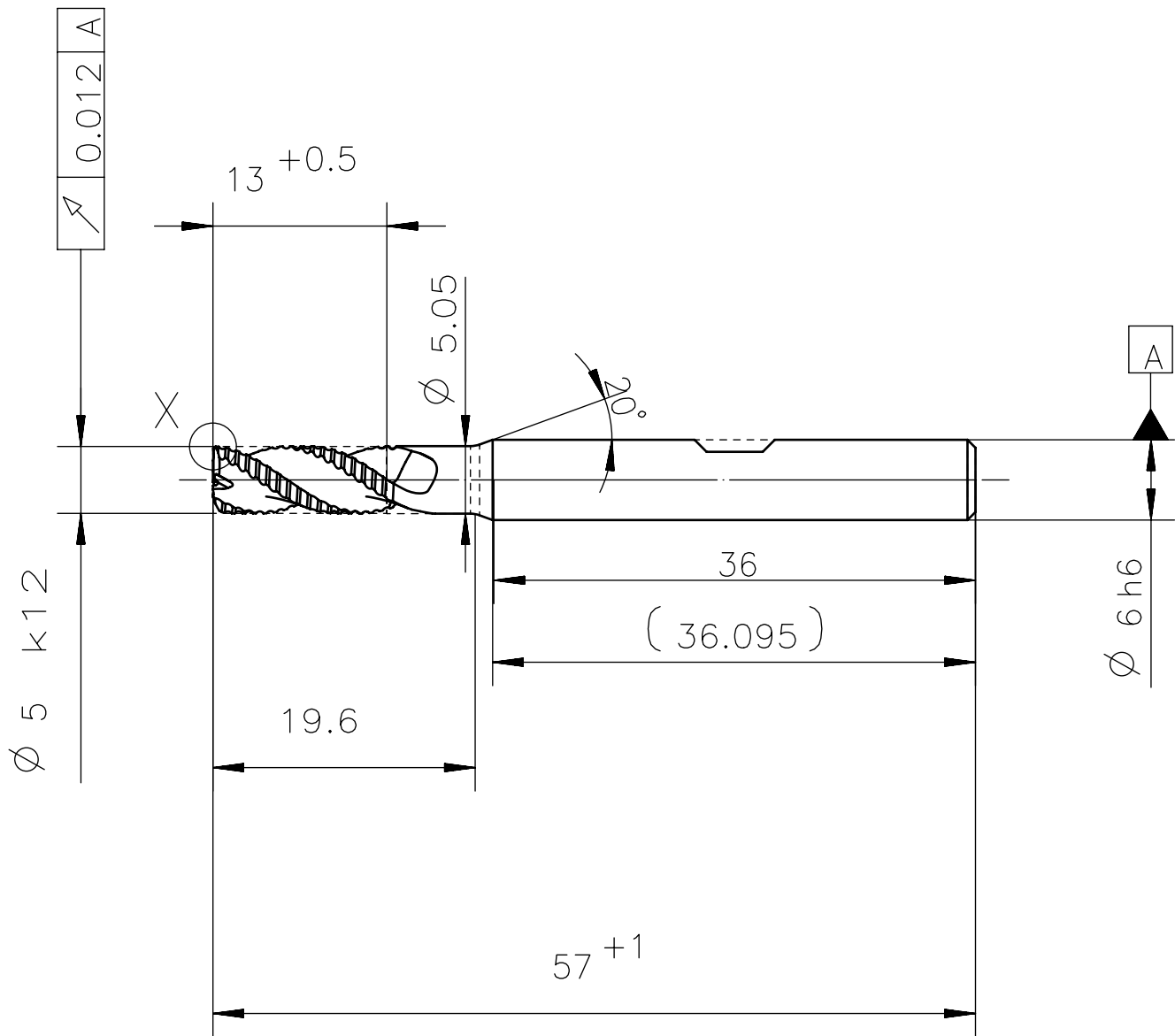

center cut

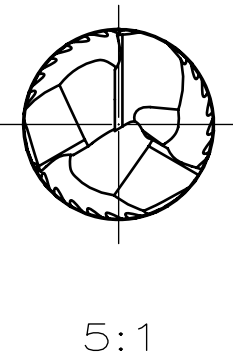

Qty.	Description				Det.	Dwg. No.		Material			
<p>Proprietary Information DIN ISO 16016:2002-5</p> <p>We reserve all Rights to this drawing including for the purpose of issuing patents and registration of petty patents. Without our written consent this drawing may not be copied, whole or partially, and may not be misused by the recipient as well as third parties. Any infraction will result in compensation for occurred damages and could lead to legal action by the author.</p>							Scale: 2:1		Format: A3		
							Material: HSS-E-PM				
							Surface:				
							Description:				
							Protostar HR KORDEL F35				
					Date		Name				
					Drawn	11.10.15	PROTOTYP				
					Checked						
							5 x 13				
					Drawing-No.:						
					1P312028-5074065				D10		
Rev.	Revision			Date	Name	Cust. No.:0		Ord.-Code:P312028-5			

5 x 13