

PROJECT: _____	UNIT TAG: _____	QUANTITY: _____
REPRESENTATIVE: _____	TYPE OF SERVICE: _____	DATE: _____
ENGINEER: _____	SUBMITTED BY: _____	DATE: _____
CONTRACTOR: _____	APPROVED BY: _____	DATE: _____
	ORDER NO.: _____	DATE: _____



UP 15-29 SU

Circulator pumps

Product photo could vary from the actual product

Conditions of Service	Pump Data	Motor Data
Flow: 10.3 US gpm	Maximum operating pressure: 145 psi	Max. power input: 97 W
Head: 5.321 ft	Liquid temperature range: 35.6 .. 230 °F	Rated power - P2: 0.148 HP
Efficiency: _____	Maximum ambient temperature: 104 °F	Rated voltage: 230 V
Liquid: Water	Approvals: UL, CSA	Main frequency: 60 Hz
Temperature: 140 °F	Type of connection: S.S. Union	Insulation class: F
NPSH required: ft	Flange standard: USA Threaded	Motor protection: CONTACT
Viscosity: _____	Pipe connection: 1 1/4" NPSM	Thermal protection: internal
Specific Gravity: 0.985	Product number: 59896784	

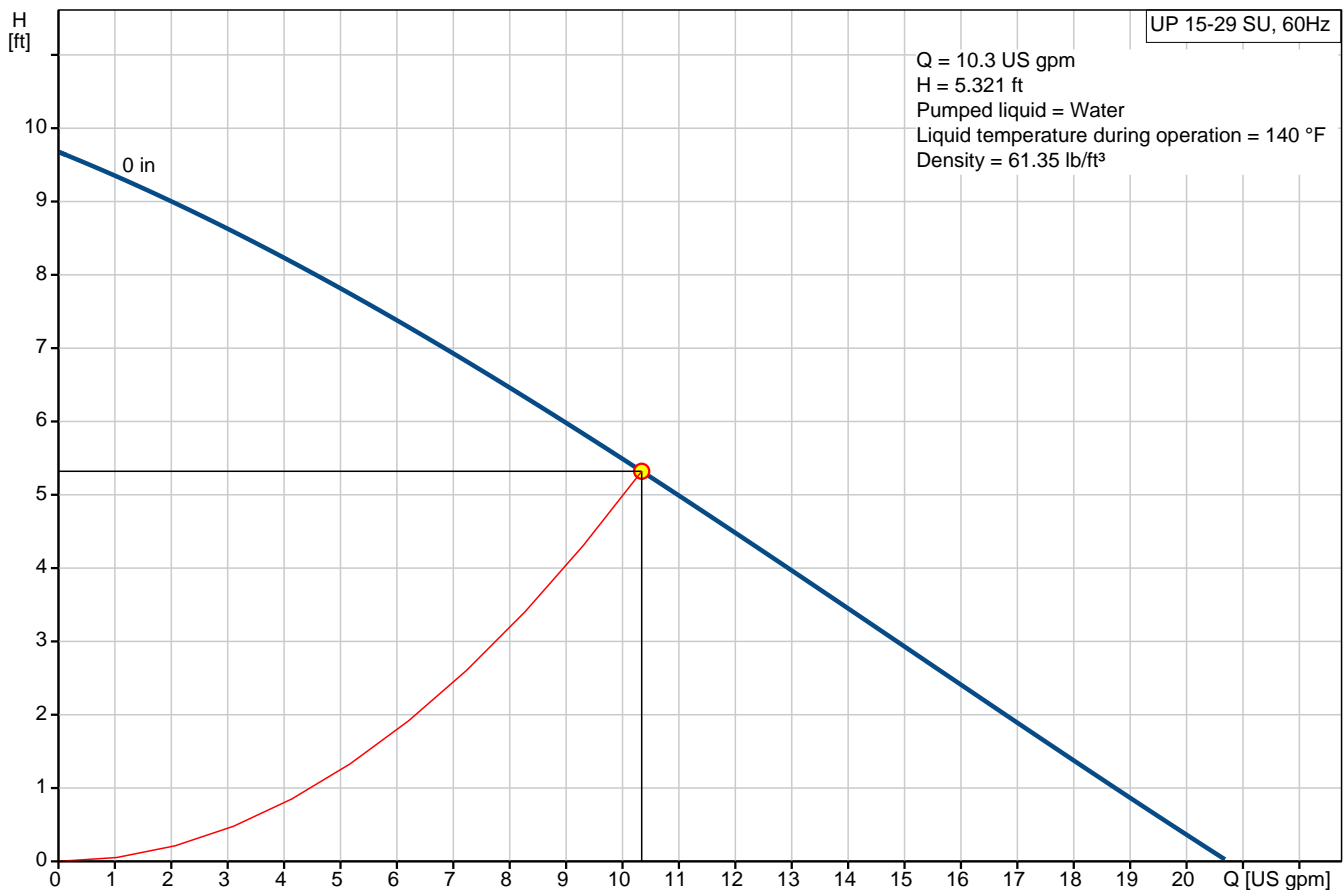

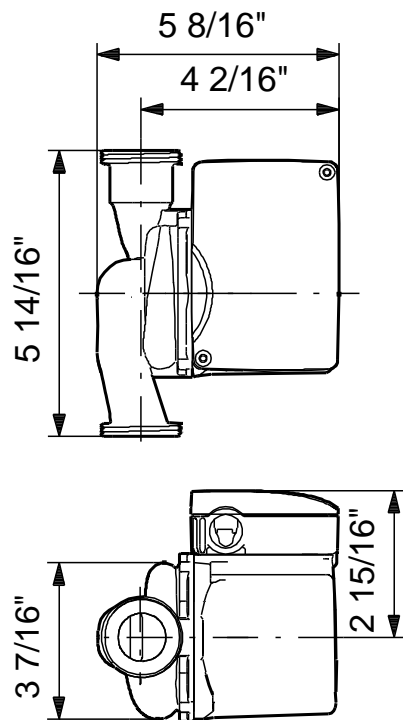

Materials:

Pump housing: Stainless steel
DIN W.-Nr. 1.4301
AISI 304

Impeller: Composite, PES

Tender Text



Product photo could vary from the actual product

Product No.: [59896784](#)

UP 15-29 SU

The pump is of the canned rotor type, i.e. pump and motor form an integral unit without shaft seal and with only two gaskets for sealing.

The bearings are lubricated by the pumped liquid.

The pump is characterized by:

- * Ceramic shaft and radial bearings.
- * Carbon axial bearing.
- * Stainless steel rotor can and bearing plate.
- * Corrosion-resistant impeller, Composite, PES.
- * Stainless steel pump housing.

The motor is a 1-phase motor.

No additional motor protection is required.

Liquid:

Pumped liquid: Water
Liquid temperature range: 35.6 .. 230 °F
Liquid temperature during operation: 140 °F
Density: 61.35 lb/ft³

Technical:

Actual calculated flow: 10.3 US gpm
Resulting head of the pump: 5.321 ft
Approvals on nameplate: UL, CSA

Materials:

Pump housing: Stainless steel
DIN W.-Nr. 1.4301
AISI 304
Impeller: Composite, PES

Installation:

Maximum ambient temperature: 104 °F
Ambient max at 176°F liquid: 176 °F
Maximum operating pressure: 145 psi
Flange standard: USA Threaded
Type of connection: S.S. Union
Pipe connection: 1 1/4" NPSM
Pressure stage: 10
Port-to-port length: 5 7/8 in

Electrical data:

Max. power input: 97 W
Rated power - P2: 0.148 HP



Company name:

Created by:

Phone:

Date:

2/21/2018

Main frequency: 60 Hz
Rated voltage: 1 x 230 V
Current in speed 3: 0.42 A
Capacitor size - run: 2 µF/400 V
Number of poles: 2
Insulation class (IEC 85): F

Others:

Gross weight: 5.4 lb

Position	Count	Description
	1	<p>UP 15-29 SU</p>  <p>Product photo could vary from the actual product</p> <p>Product No.: 59896784</p> <p>The pump is of the canned rotor type, i.e. pump and motor form an integral unit without shaft seal and with only two gaskets for sealing. The bearings are lubricated by the pumped liquid. The pump is characterized by:</p> <ul style="list-style-type: none"> * Ceramic shaft and radial bearings. * Carbon axial bearing. * Stainless steel rotor can and bearing plate. * Corrosion-resistant impeller, Composite, PES. * Stainless steel pump housing. <p>The motor is a 1-phase motor. No additional motor protection is required.</p> <p>Liquid:</p> <p>Pumped liquid: Water</p> <p>Liquid temperature range: 35.6 .. 230 °F</p> <p>Liquid temperature during operation: 140 °F</p> <p>Density: 61.35 lb/ft³</p> <p>Technical:</p> <p>Actual calculated flow: 10.3 US gpm</p> <p>Resulting head of the pump: 5.321 ft</p> <p>Approvals on nameplate: UL, CSA</p> <p>Materials:</p> <p>Pump housing: Stainless steel DIN W.-Nr. 1.4301 AISI 304</p> <p>Impeller: Composite, PES</p> <p>Installation:</p> <p>Maximum ambient temperature: 104 °F</p> <p>Ambient max at 176°F liquid: 176 °F</p> <p>Maximum operating pressure: 145 psi</p> <p>Flange standard: USA Threaded</p> <p>Type of connection: S.S. Union</p> <p>Pipe connection: 1 1/4" NPSM</p> <p>Pressure stage: 10</p> <p>Port-to-port length: 5 7/8 in</p> <p>Electrical data:</p> <p>Max. power input: 97 W</p> <p>Rated power - P2: 0.148 HP</p> <p>Main frequency: 60 Hz</p> <p>Rated voltage: 1 x 230 V</p>



Company name:

Created by:

Phone:

Date:

2/21/2018

Position	Count	Description
		Current in speed 3: 0.42 A Capacitor size - run: 2 μ F/400 V Number of poles: 2 Insulation class (IEC 85): F Others: Gross weight: 5.4 lb

59896784 UP 15-29 SU 60 Hz

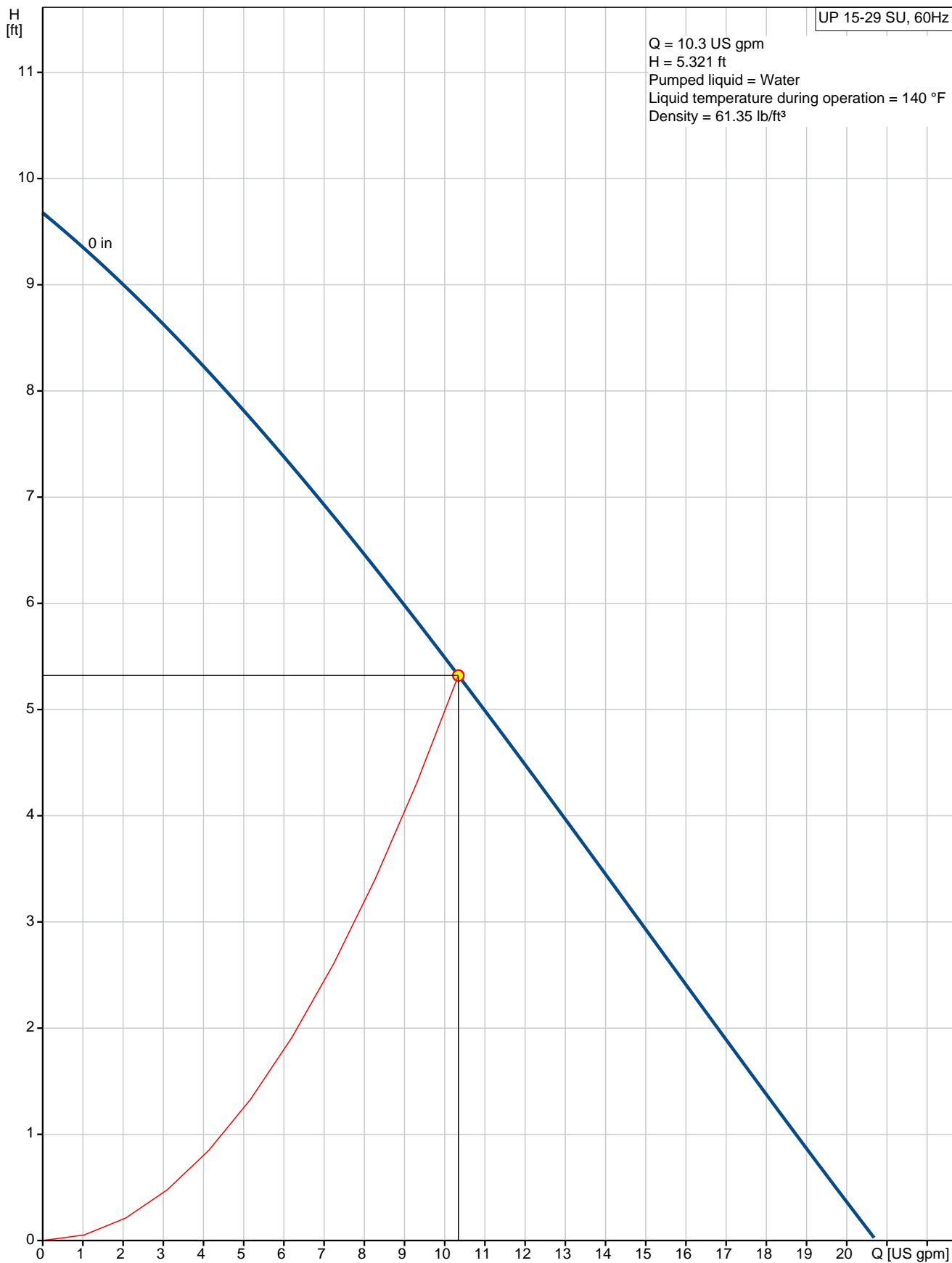

Description	Value
General information:	
Product name:	UP 15-29 SU
Product No.:	59896784
EAN:	5700837428163
Technical:	
Speed Number:	1
Actual calculated flow:	10.3 US gpm
Max flow:	20.7 US gpm
Resulting head of the pump:	5.321 ft
Head max:	9.843 ft
Approvals on nameplate:	UL, CSA
Materials:	
Pump housing:	Stainless steel
	DIN W.-Nr. 1.4301
	AISI 304
Impeller:	Composite, PES
Installation:	
Maximum ambient temperature:	104 °F
Ambient max at 176°F liquid:	176 °F
Maximum operating pressure:	145 psi
Flange standard:	USA Threaded
Type of connection:	S.S. Union
Pipe connection:	1 1/4" NPSM
Pressure stage:	10
Port-to-port length:	5 7/8 in
Liquid:	
Pumped liquid:	Water
Liquid temperature range:	35.6 .. 230 °F
Liquid temperature during operation:	140 °F
Density:	61.35 lb/ft³
Electrical data:	
Max. power input:	97 W
Rated power - P2:	0.148 HP
Main frequency:	60 Hz
Rated voltage:	1 x 230 V
Current in speed 3:	0.42 A
Capacitor size - run:	2 µF/400 V
Number of poles:	2
Insulation class (IEC 85):	F
Motor protection:	CONTACT
Thermal protec:	internal
Controls:	
Pos term box:	9H
Others:	
Gross weight:	5.4 lb

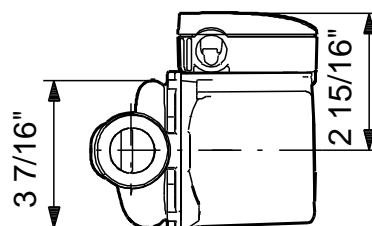
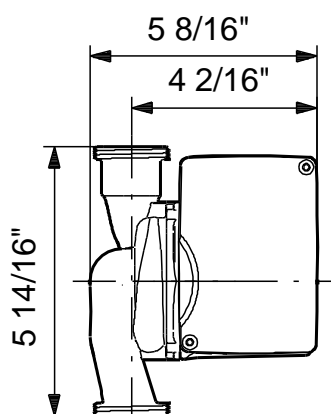
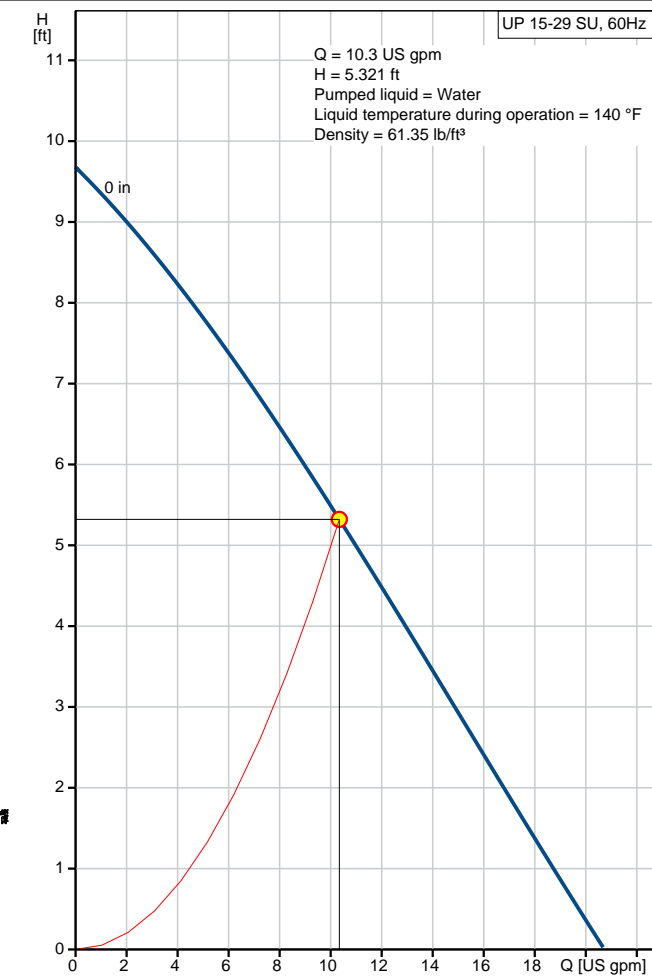

59896784 UP 15-29 SU 60 Hz

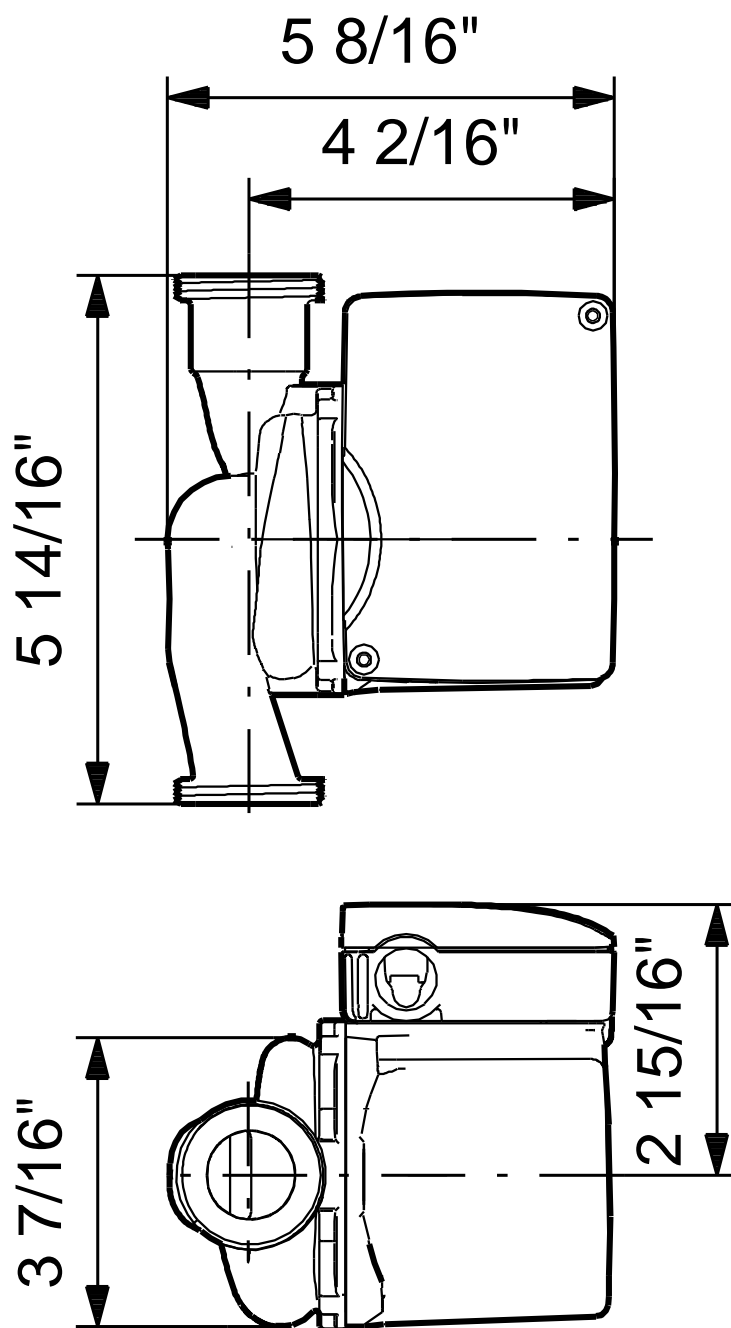

Note! All units are in [mm] unless otherwise stated.
Disclaimer: This simplified dimensional drawing does not show all details.



Company name:

Created by:

Phone:

Date:

2/21/2018

Order Data:

Product name: UP 15-29 SU

Amount: 1

Product No.: 59896784

Total: Price on request
